



User manual



 **alerta**[®]
aqua

ALT-SC150
Aqua Shower Commode Chair



UK Version

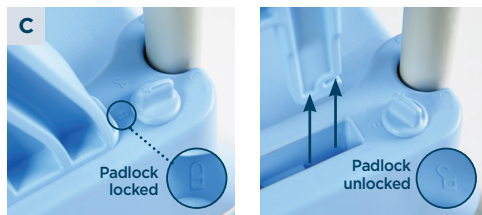
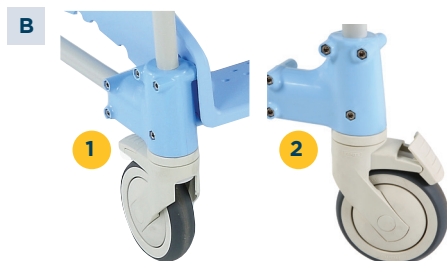
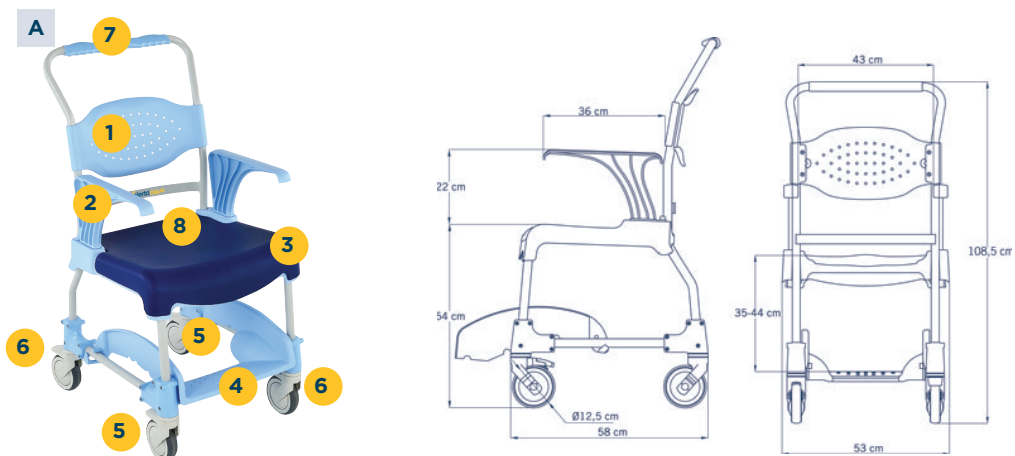

Measurement from floor to underside of seat: 45cm

Measurement from floor to underside of commode bowl: 35cm

General



To avoid damage during handling or use of the chair please read this manual carefully.

Aqua is a shower and toilet chair designed to make hygiene easier for people with mobility difficulties. It is intended for use in a shower, at the washbasin or over a toilet, and can also be used to transport patients.

Aqua can be used with patients weighing up to 150 kg.

Measurements (See image A)

A 1	Back	A 5	Wheels with brake
A 2	Armrest	A 6	Wheels without brake
A 3	Seat	A 7	Carer handhold
A 4	Footrest	A 8	Seat cover

Handling (See image B)

Getting over small steps

If the **chair is empty**, put your foot on the wheel fixing component.

If the **chair is occupied**, use the care assistant's hand-hold with the chair facing backwards.

Brake the chair (image **B 1** - **B 2**)

Lock the wheels by stepping on the brake pedal. The chair is more stable if the wheels are turned outwards.

Transfer

Make sure the brake is on the wheels before starting to transfer the patient to another support (toilet, bed...). Remove the armrest beforehand if necessary.

Armrest (see image C)

Armrest can be extracted using the wheel.

Seat Cover (See image D)

Easy to extract.

Footrest (See image E)

Detachable and easy to use.
Adjustable to 5 positions

Guarantee

2 year guarantee against manufacturing defects. The guarantee and liability expire in the event of interventions by unauthorised staff or failure to follow the user and maintenance instructions.

Maintenance

Clean regularly with non-abrasive products. Rinse and dry. Keep the wheels and brakes free of dirt and soap.

Safety



Do not use the chair if you notice any defects.

Failure to do this may result in material damage or physical injury.

Do not stand on the footrest (chair may overturn). Take care with the seat cover and the armrest, danger of entrapment.

The patient must not rock in the chair, because it may overturn.

Transfer the patient at a suitable speed.

CE EU 2017/745



CS Lifesciences Europe Ltd

The Black Church
St. Mary's Place
Dublin 7
D07 P4AX
Ireland

eurep@cslifesciences.com

Rev: 2021.10

Making **cutting-edge** medical equipment **affordable**

Head Office

Alerta Medical
4 Symington Place
Riverside Business Park
Irvine
KA11 5DE
United Kingdom

www.alertamedical.com

